

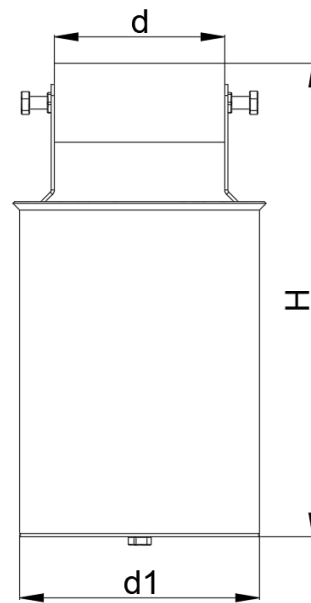

LD - Silencer

Black steel

Silencer for safety vent. Made from 2mm black steel and painted in RAL9005. Foam of 10mm is used for sound attenuation.



Diameter	Thickness	Diameter	Dimension	Weight
Ød, mm	s, mm	Ød1, mm	H, mm	kg
76	2	127	300	3,2
102	2	152	300	3,6
108	2	152	300	3,7
127	2	203	300	5,0
152	2	242	300	6,8